

Profile System Setup Guide



Tools included in Accessory Kit:

- Rounded hex wrench multi tool
- Hex wrench multi tool
- Screwdriver with Phillip's and flathead double sided bits
- Wrench

Warning: Parts of this unit weigh as much as 25lbs (12kg). Think before lifting/ handling equipment. Adopt a stable posture to maintain balance evenly distributed between both legs. Get a good hold on the parcel and keep it close to the body when carrying. Maintain straight posture and refrain from twisting and bending while carrying the load.

Ensure you have a secure grip on any component before lifting.

Profile System Setup Guide

Tabletop Cart Assembly

Complete tabletop cart with a control unit, purple power supply, D300 amplifier, and tabletop depicted below, shown facing front. All profile cart systems utilize this core assembly.



Note that legs and table top are designed with off center mounting points. Both will extend out forward from the electric stand a greater distance than they will extend from the rear of the electric stand. The blue face of the power stand is considered to be the front.

Align the screw holes on the wheel legs with those on the electrical stand. Screw the bolts and washers in tightly on both sides. Use rounded hex wrench multi tool.

Profile System Setup Guide



Remove 4 x 14mm bolts and washers from table top.

US: Diagnosys LLC; 55 Technology Drive, Suite 100, Lowell, MA 01851; 978-458-1600; sales@diagnosysllc.com
EU: Diagnosys Vision Ltd; Office 117, DOC Building, Balheary Road, Swords, Dublin, K67 E5A0, Ireland; +44 (0) 1223 520699; mail@diagnosysvision.com
UK: Diagnosys UK Ltd; 5 Trust Court, Chivers Way, Vision Park Histon, Cambridge, CB24 9PW, UK; +44 (0) 1223 520699; mail@diagnosysuk.co.uk
www.diagnosysllc.com

Profile System Setup Guide



Secure tabletop to electric stand with same 4 x 14mm bolts and washers. Connect electric stand power cord directly to wall outlet to slightly raise power stand for better access to mounting holes. Use Up/Down switch at front of power stand.



Locate mounting rails underneath tabletop with openings at backside of tabletop. There is a set on the left and on the right.

Profile System Setup Guide



Slide Control unit into place underneath tabletop, into the left set of rails. Slide control unit mounting pins and push forward until locking mechanism click. Secure to locking mechanism by tightening flat head screw.



Slide Purple power unit into right set of rails underneath table. Secure to locking mechanism by tightening flat head screw.

US: Diagnosys LLC; 55 Technology Drive, Suite 100, Lowell, MA 01851; 978-458-1600; sales@diagnosysllc.com
EU: Diagnosys Vision Ltd; Office 117, DOC Building, Balheary Road, Swords, Dublin, K67 E5A0, Ireland; +44 (0) 1223 520699; mail@diagnosysvision.com
UK: Diagnosys UK Ltd; 5 Trust Court, Chivers Way, Vision Park Histon, Cambridge, CB24 9PW, UK; +44 (0) 1223 520699; mail@diagnosysuk.co.uk
www.diagnosysllc.com

Profile System Setup Guide



Connect control box L-shaped power cable to round port at side of purple power unit.



Profile System Setup Guide



Install Amplifier holder by screwing into place as shown in image, using Loctite on the threads of the screw.



Insert amplifier so bottom rests on circled part of holder

Profile System Setup Guide



Connect amplifier to patient port on control box



Profile System Setup Guide

Profile Cart with Colordome on Joystick Slider

Complete Profile cart with Colordome on joystick slider assembly depicted below



Start with an assembled tabletop cart. Attach Joystick mount to slider as shown below

US: Diagnosys LLC; 55 Technology Drive, Suite 100, Lowell, MA 01851; 978-458-1600; sales@diagnosysllc.com
EU: Diagnosys Vision Ltd; Office 117, DOC Building, Balheary Road, Swords, Dublin, K67 E5A0, Ireland; +44 (0) 1223 520699; mail@diagnosysvision.com
UK: Diagnosys UK Ltd; 5 Trust Court, Chivers Way, Vision Park Histon, Cambridge, CB24 9PW, UK; +44 (0) 1223 520699; mail@diagnosysuk.co.uk
www.diagnosysllc.com

Profile System Setup Guide



Attach Chin rest post to slider as shown below

Profile System Setup Guide



Insert top half of chin rest post into lower half. Loosen screw at top of lower half to allow upper half to insert. Tighten to secure at any desired height.



Attach complete slider assembly to tabletop as shown below

Profile System Setup Guide



Attach Ergotron arm mounting post to table top as shown below



Slide Keyboard tray Ergotron arm onto post. There will be a plastic “washer” sleeve that will sit between arm and post to prevent post from wobbling. Remove plastic wrap from keyboard tray.

Profile System Setup Guide



Attach square plate Ergotron arm to back of all in one computer. 4 x Phillip's screws will be supplied with computer to attach Ergotron arm.



Slide Ergotron arm with computer onto post. There will be a plastic "washer" sleeve that will sit between arm and post to prevent post from wobbling.



Profile System Setup Guide

Attach the Colordome Power Supply holder to the bottom of the electric stand. Start by unscrewing the two silver hex nuts. Slide the metal base plate into place, align indicated cutouts with indicated screws. Slide left half and right half of holder into place on top of metal plate. Finish by reattaching silver hex nuts to secure power supply holder.



Place Colordome Power Supply into holder

Profile System Setup Guide



Attach Colordome to joystick mount. This usually requires two people to handle the dome and to work the latch on the joystick mount. Shoe on Colordome will press gold colored locking mechanism, which will cause the grey clasp to rotate 90 degrees and grab onto shoe. Push on grey clasp until a secure fit is made. Flip gold switch in line with grey clasp to hold clasp in locked position.



Slide Colordome cable through opening at back of tabletop

Profile System Setup Guide



Connect Colordome to Colordome Power Supply



Connect Colordome coax video cable to Video in coax connector located on the Colordome Power Supply. Use USB B to USB A cable to connect USB video out on CD Power Supply to USB port of Computer.

Profile System Setup Guide

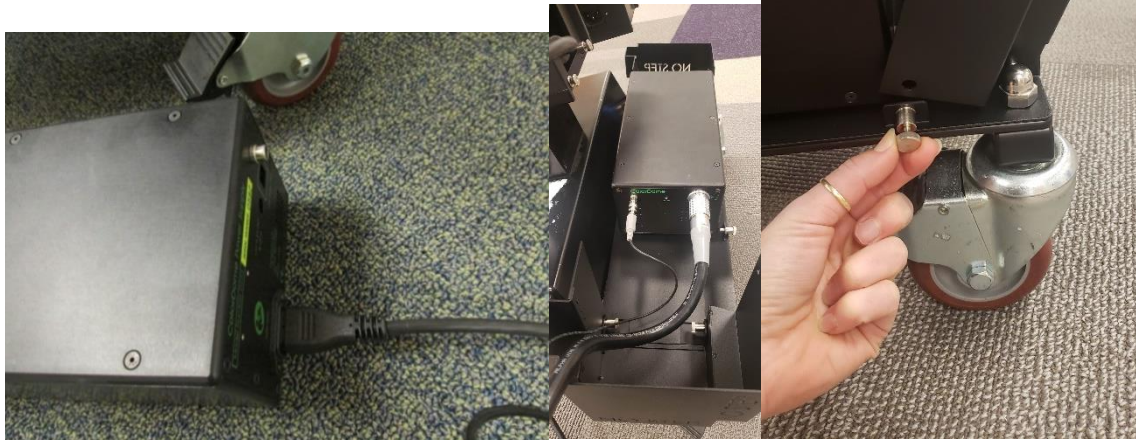

Connect Colordome to Stimulator port on Control Box

US: Diagnosys LLC; 55 Technology Drive, Suite 100, Lowell, MA 01851; 978-458-1600; sales@diagnosysllc.com

EU: Diagnosys Vision Ltd; Office 117, DOC Building, Balheary Road, Swords, Dublin, K67 E5A0, Ireland; +44 (0) 1223 520699; mail@diagnosysvision.com

UK: Diagnosys UK Ltd; 5 Trust Court, Chivers Way, Vision Park Histon, Cambridge, CB24 9PW, UK; +44 (0) 1223 520699; mail@diagnosysuk.co.uk

www.diagnosysllc.com

Profile System Setup Guide



Connect USB from Control Box to computer



Connect power cords from the Colordome power supply, Electric stand, and Dell computer to any of power outlets on purple power unit.

Profile System Setup Guide



Then connect Grey line cord to wall outlet.

Profile System Setup Guide

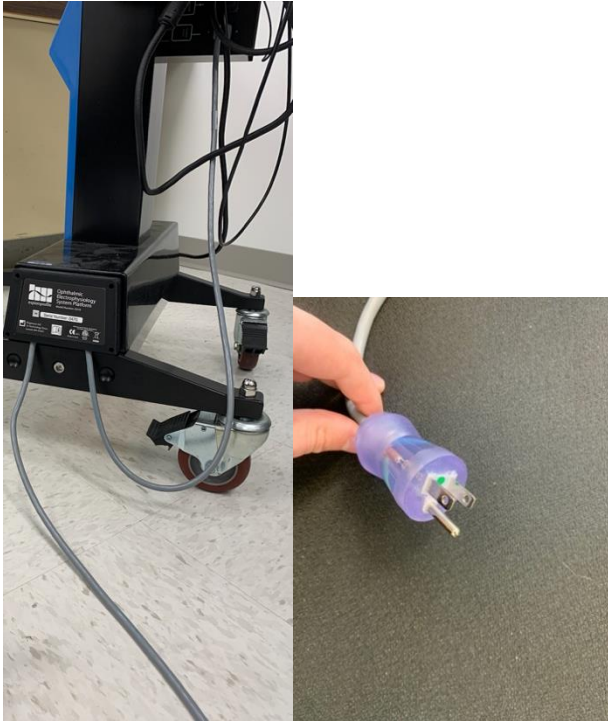

Power on all components with power switch at front of purple power unit

Profile System Setup Guide

Colordome with Ergotron Operating room arm mount (Colordome O.R cart)

Complete Profile cart with Colordome OR cart assembly depicted below



Start with an assembled tabletop cart with control box, power unit, and amplifier.

Profile System Setup Guide



Attach mounting post as shown. This will be used to support the Ergotron arms holding the Colordome, computer, and keyboard tray.



Assemble the ergotron arm for Colordome as shown in the images below

Profile System Setup Guide



Profile System Setup Guide

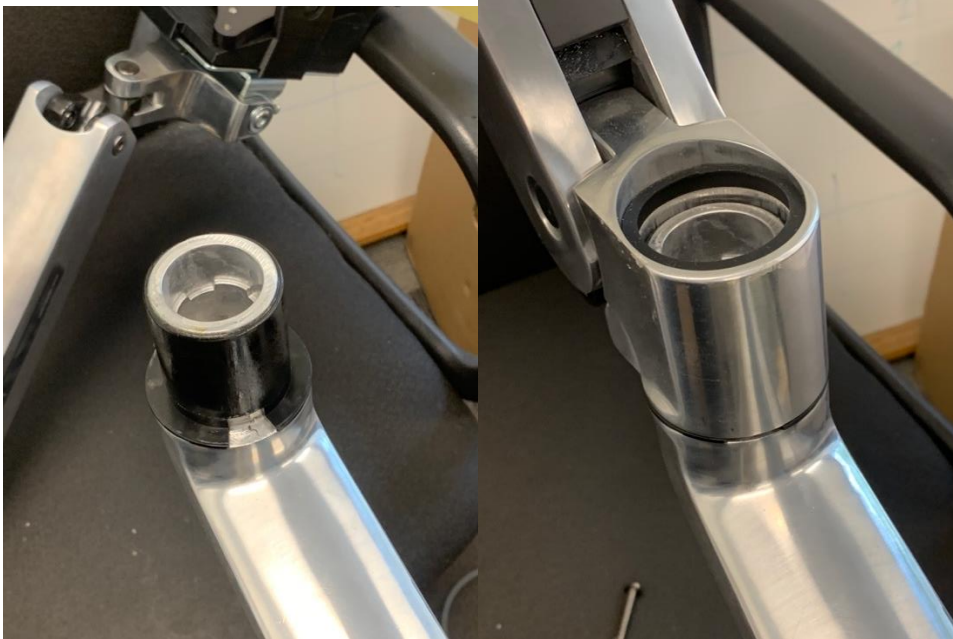

Profile System Setup Guide

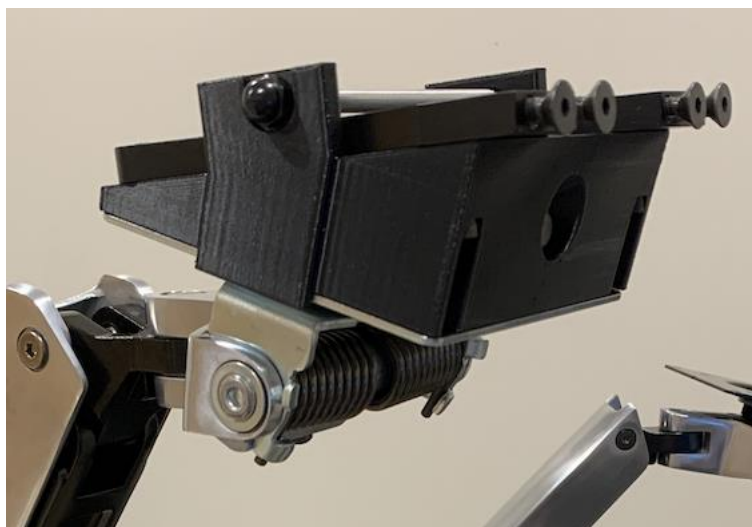
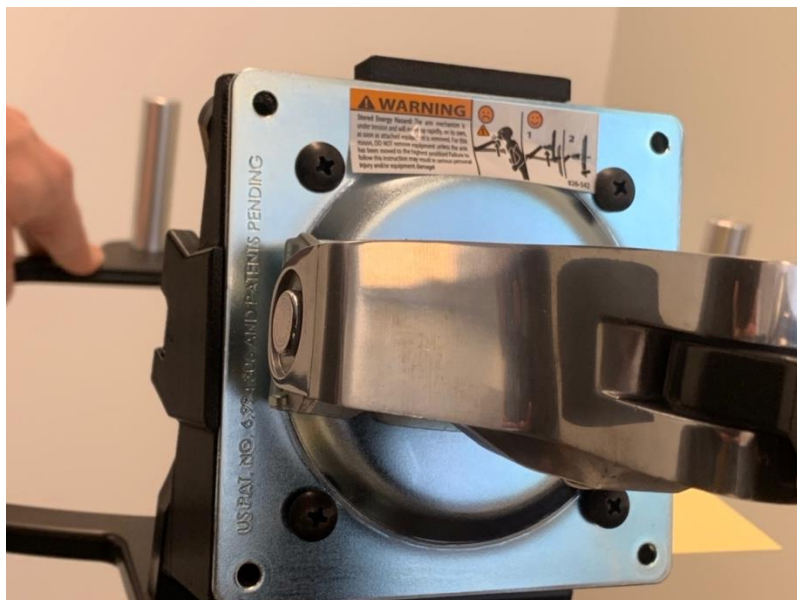

Profile System Setup Guide



Install Colordome into opening of collar mount. Remove long screw shown in image. Open both tabs at top of collar

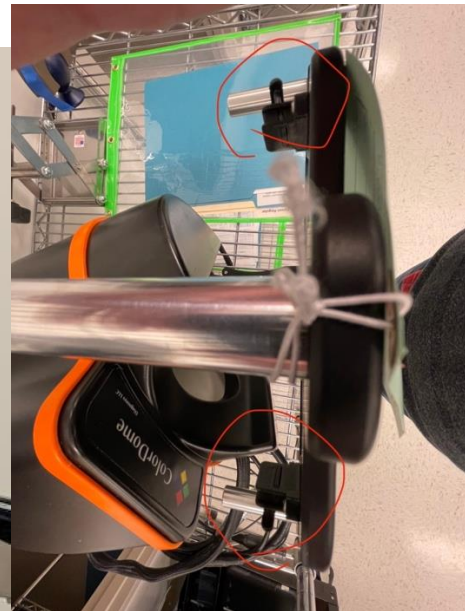
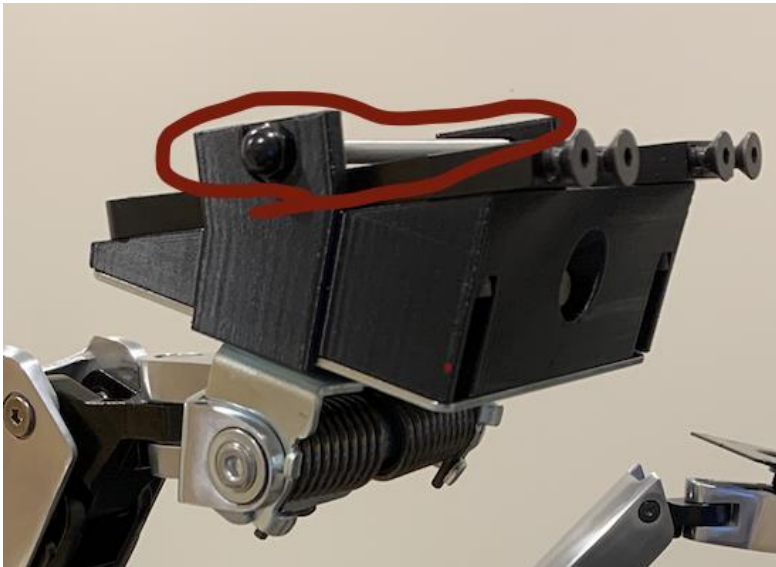

Depress both tabs as shown.

Profile System Setup Guide

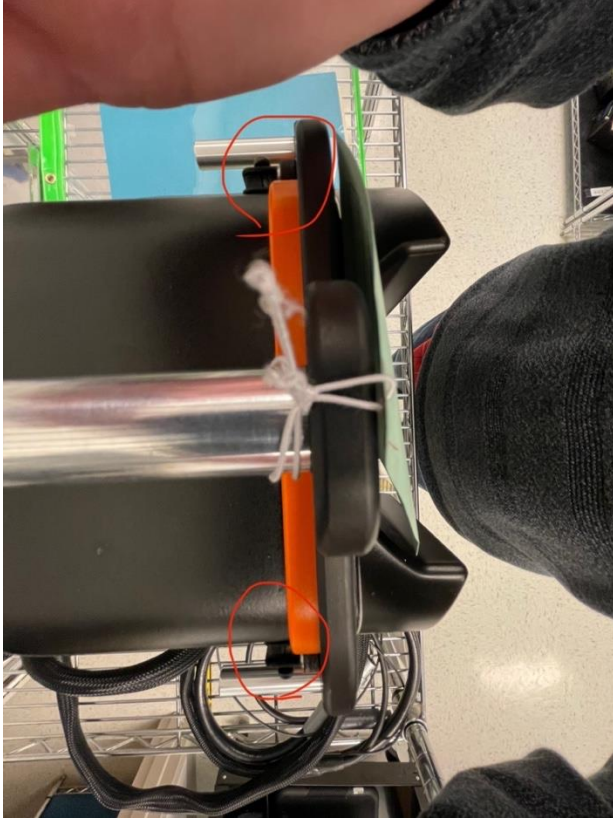

Use long screw to secure bottom of Colordome to mount.



Attach the Colordome Power Supply holder to the bottom of the electric stand. Start by unscrewing the two silver hex nuts. Slide the metal base plate into place, align indicated cutouts with indicated screws. Slide left half and right half of holder into place on top of metal plate. Finish by reattaching silver hex nuts to secure power supply holder.

US: Diagnosys LLC; 55 Technology Drive, Suite 100, Lowell, MA 01851; 978-458-1600; sales@diagnosysllc.com

EU: Diagnosys Vision Ltd; Office 117, DOC Building, Balheary Road, Swords, Dublin, K67 E5A0, Ireland; +44 (0) 1223 520699; mail@diagnosysvision.com

UK: Diagnosys UK Ltd; 5 Trust Court, Chivers Way, Vision Park Histon, Cambridge, CB24 9PW, UK; +44 (0) 1223 520699; mail@diagnosysuk.co.uk

www.diagnosysllc.com

Profile System Setup Guide



Place Colordome Power Supply into holder

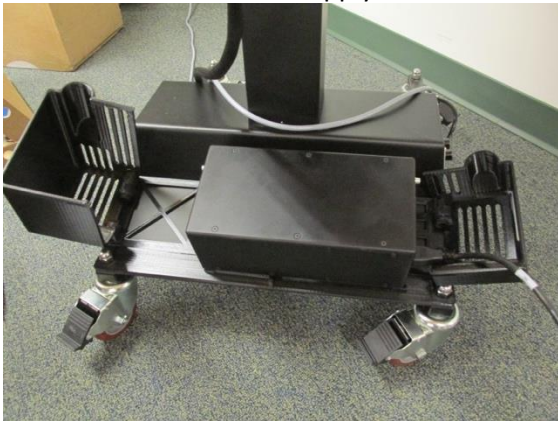

Slide Colordome cable through opening at back of tabletop

Profile System Setup Guide



Connect Colordome to Colordome Power Supply



Connect Colordome coax video cable to Video in coax connector located on the Colordome Power Supply. Use USB B to USB A cable to connect USB video out on CD Power Supply to USB port of Computer.

Connect Colordome to Stimulator port on Control Box

Profile System Setup Guide



Attach chin rest post assembly to tabletop

Profile System Setup Guide

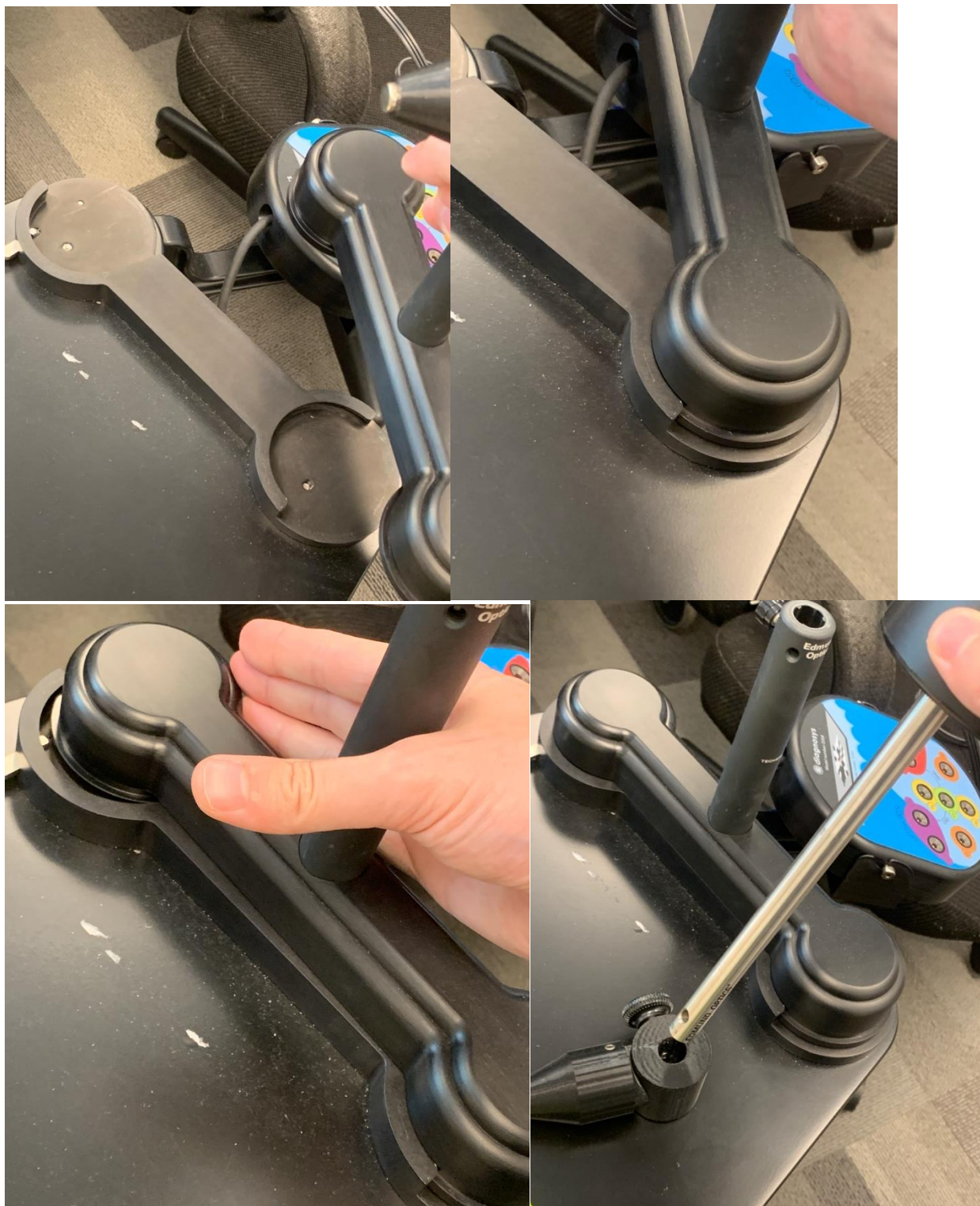

US: Diagnosys LLC; 55 Technology Drive, Suite 100, Lowell, MA 01851; 978-458-1600; sales@diagnosysllc.com
EU: Diagnosys Vision Ltd; Office 117, DOC Building, Balheary Road, Swords, Dublin, K67 E5A0, Ireland; +44 (0) 1223 520699; mail@diagnosysvision.com
UK: Diagnosys UK Ltd; 5 Trust Court, Chivers Way, Vision Park Histon, Cambridge, CB24 9PW, UK; +44 (0) 1223 520699; mail@diagnosysuk.co.uk
www.diagnosysllc.com

Profile System Setup Guide

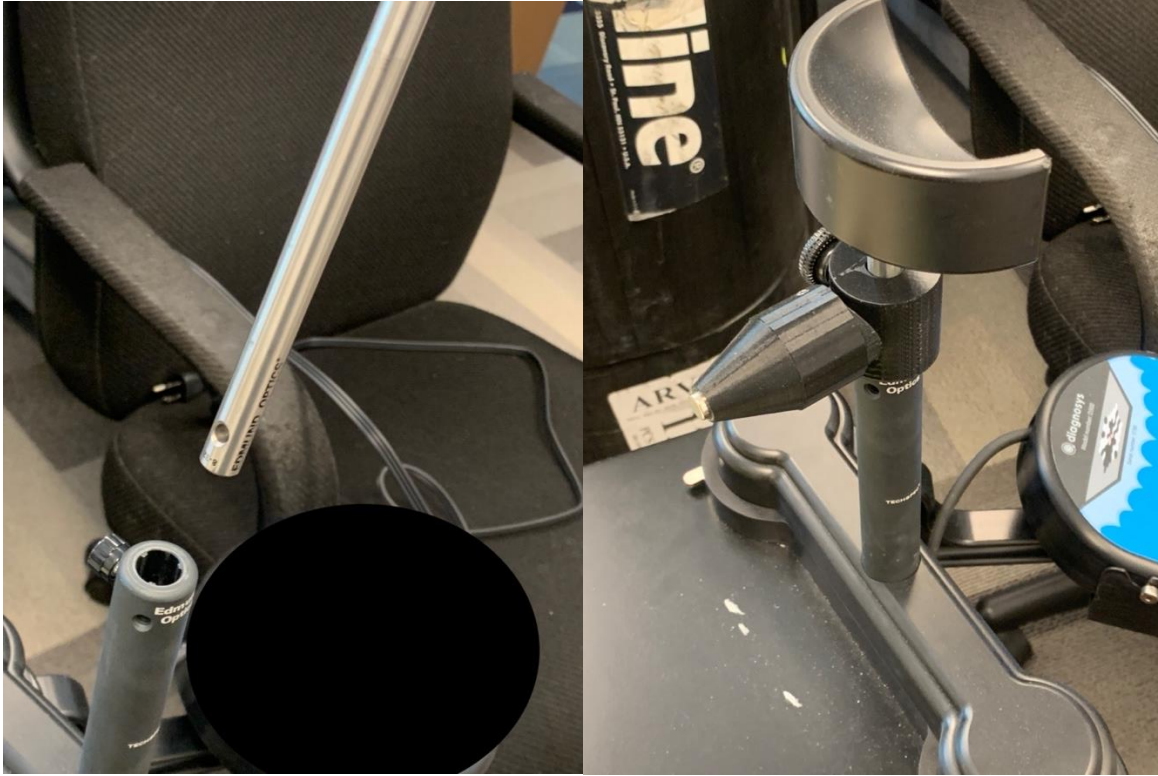

Attach ergotron arm to back of computer using 4 Phillips head screws.



Slide Keyboard arm tray and Computer arm onto post as shown

US: Diagnosys LLC; 55 Technology Drive, Suite 100, Lowell, MA 01851; 978-458-1600; sales@diagnosysllc.com
EU: Diagnosys Vision Ltd; Office 117, DOC Building, Balheary Road, Swords, Dublin, K67 E5A0, Ireland; +44 (0) 1223 520699; mail@diagnosysvision.com
UK: Diagnosys UK Ltd; 5 Trust Court, Chivers Way, Vision Park Histon, Cambridge, CB24 9PW, UK; +44 (0) 1223 520699; mail@diagnosysuk.co.uk
www.diagnosysllc.com

Profile System Setup Guide



Connect USB from Control Box to computer



Connect USB from Video converter to computer if not yet already done.

US: Diagnosys LLC; 55 Technology Drive, Suite 100, Lowell, MA 01851; 978-458-1600; sales@diagnosysllc.com
EU: Diagnosys Vision Ltd; Office 117, DOC Building, Balheary Road, Swords, Dublin, K67 E5A0, Ireland; +44 (0) 1223 520699; mail@diagnosysvision.com
UK: Diagnosys UK Ltd; 5 Trust Court, Chivers Way, Vision Park Histon, Cambridge, CB24 9PW, UK; +44 (0) 1223 520699; mail@diagnosysuk.co.uk
www.diagnosysllc.com

Profile System Setup Guide

Connect power cords for the Colordome power supply, Electric stand, and Dell computer to any of power output on purple power unit.

Connect Grey line cord to power in of purple power supply.

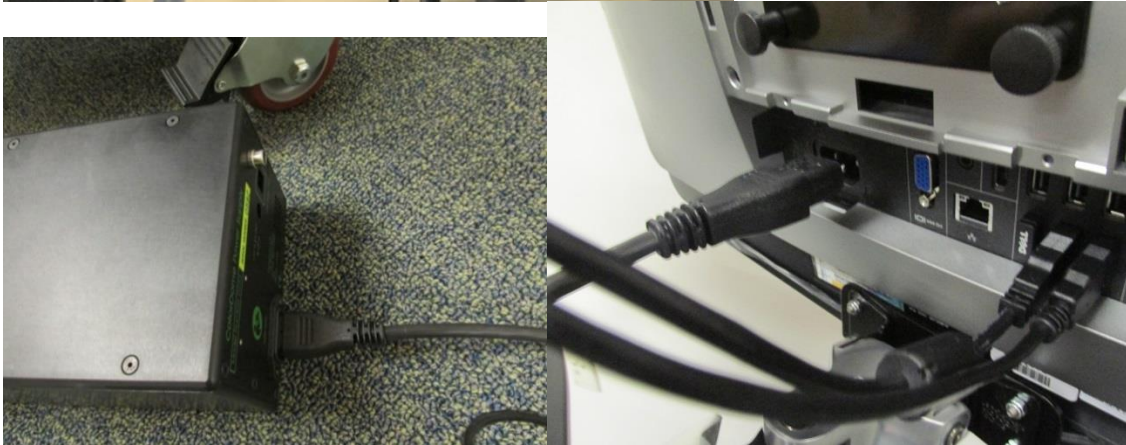
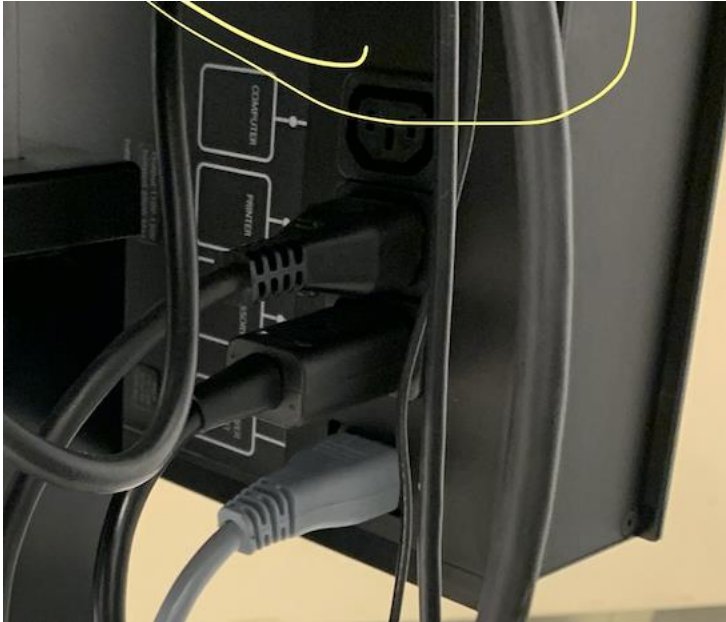

Then connect Grey line cord to wall outlet.

Profile System Setup Guide

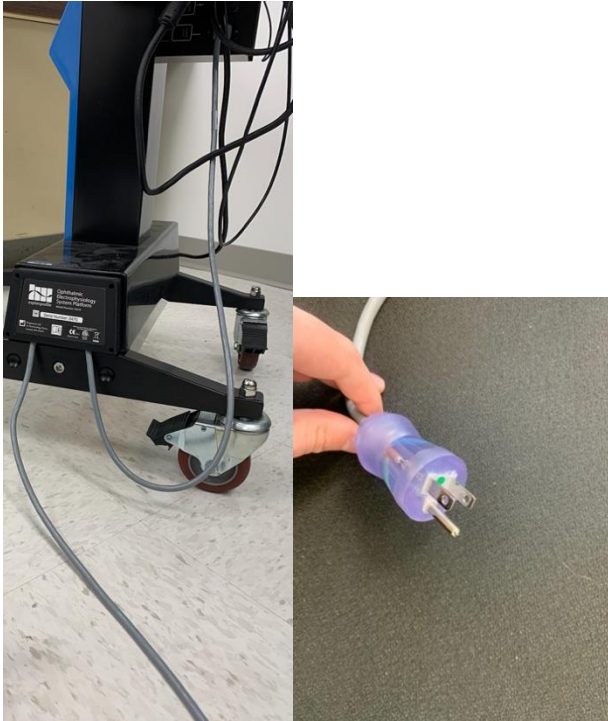

Power on all components with power switch at front of purple power unit.

Profile System Setup Guide

Multifocal cart with LCD monitor

Complete Multifocal cart with LCD monitor depicted below. Start with assembled tabletop cart with control unit, power supply and amplifier



Profile System Setup Guide

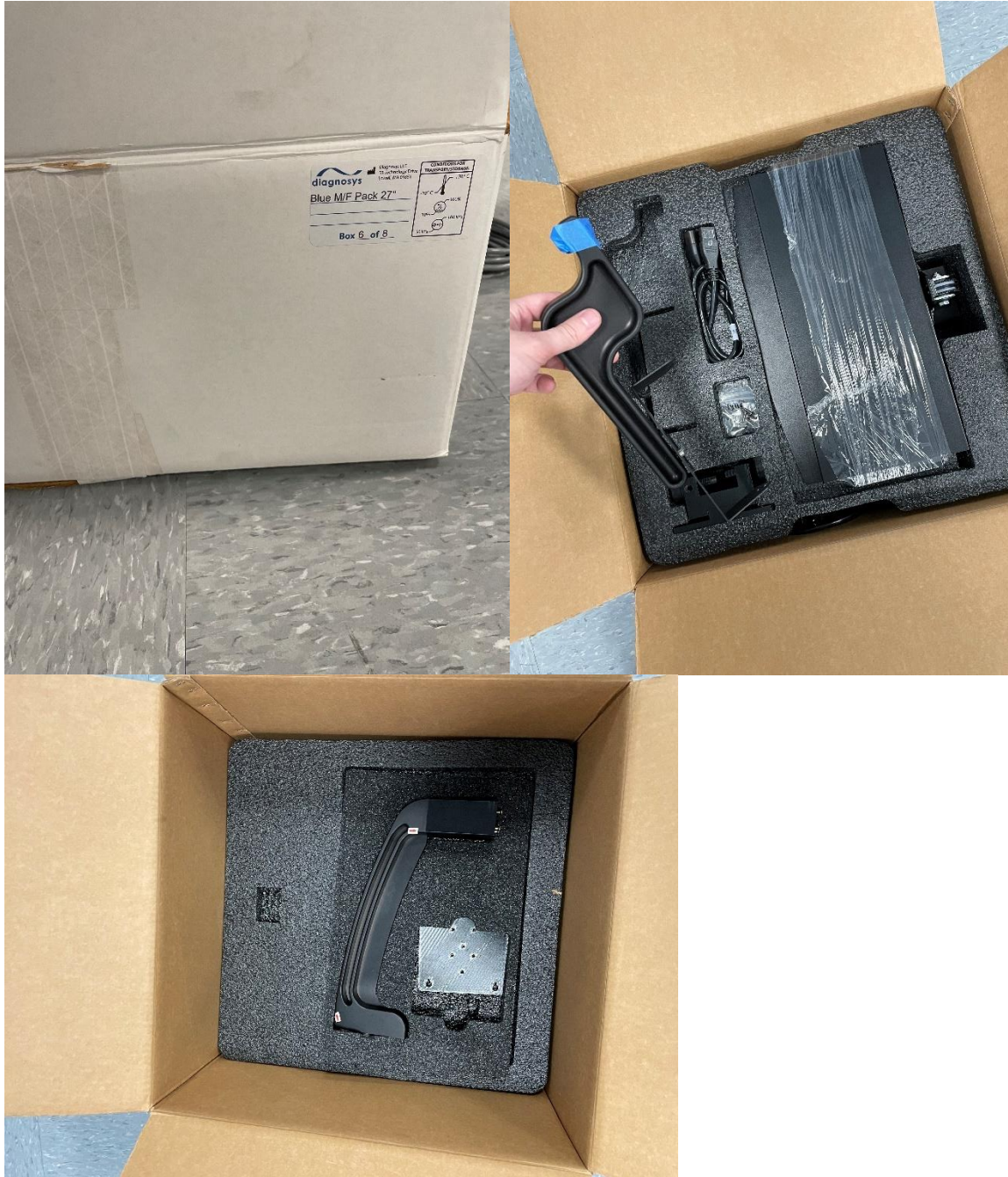

US: Diagnosys LLC; 55 Technology Drive, Suite 100, Lowell, MA 01851; 978-458-1600; sales@diagnosysllc.com
EU: Diagnosys Vision Ltd; Office 117, DOC Building, Balheary Road, Swords, Dublin, K67 E5A0, Ireland; +44 (0) 1223 520699; mail@diagnosysvision.com
UK: Diagnosys UK Ltd; 5 Trust Court, Chivers Way, Vision Park Histon, Cambridge, CB24 9PW, UK; +44 (0) 1223 520699; mail@diagnosysuk.co.uk
www.diagnosysllc.com

Profile System Setup Guide



Note: Diagnosys sells the monitor cart system as a full system or as an auxiliary system. A full system includes a computer, control unit, power unit, LCD monitor, camera, amplifier, computer mount, standard chin rest assembly, and keyboard tray. Look for the Blue MF pack for a full system mounting parts. An auxiliary unit includes only the LCD monitor, monitor mount, standard chin rest assembly, and camera. Look for a auxiliary cart M/F pack for auxiliary cart mounting parts.

Profile System Setup Guide

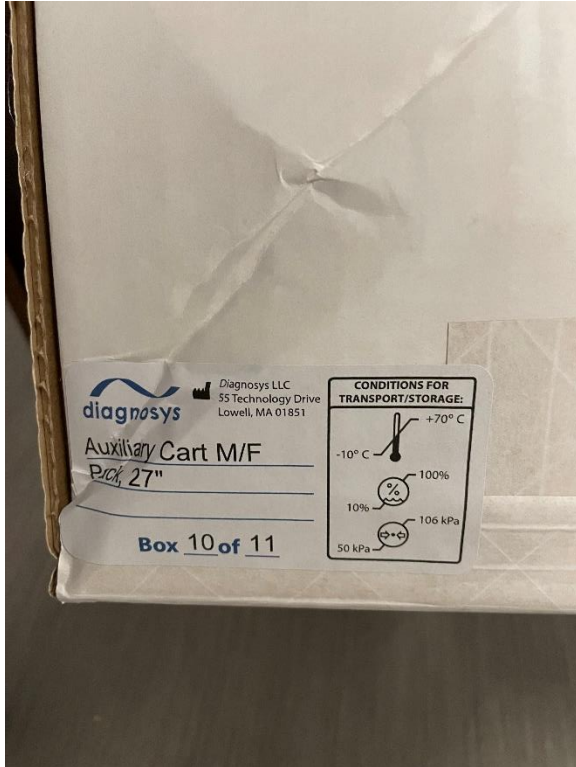

US: Diagnosys LLC; 55 Technology Drive, Suite 100, Lowell, MA 01851; 978-458-1600; sales@diagnosysllc.com
EU: Diagnosys Vision Ltd; Office 117, DOC Building, Balheary Road, Swords, Dublin, K67 E5A0, Ireland; +44 (0) 1223 520699; mail@diagnosysvision.com
UK: Diagnosys UK Ltd; 5 Trust Court, Chivers Way, Vision Park Histon, Cambridge, CB24 9PW, UK; +44 (0) 1223 520699; mail@diagnosysuk.co.uk
www.diagnosysllc.com

Profile System Setup Guide



US: Diagnosys LLC; 55 Technology Drive, Suite 100, Lowell, MA 01851; 978-458-1600; sales@diagnosysllc.com
EU: Diagnosys Vision Ltd; Office 117, DOC Building, Balheary Road, Swords, Dublin, K67 E5A0, Ireland; +44 (0) 1223 520699; mail@diagnosysvision.com
UK: Diagnosys UK Ltd; 5 Trust Court, Chivers Way, Vision Park Histon, Cambridge, CB24 9PW, UK; +44 (0) 1223 520699; mail@diagnosysuk.co.uk
www.diagnosysllc.com

Profile System Setup Guide

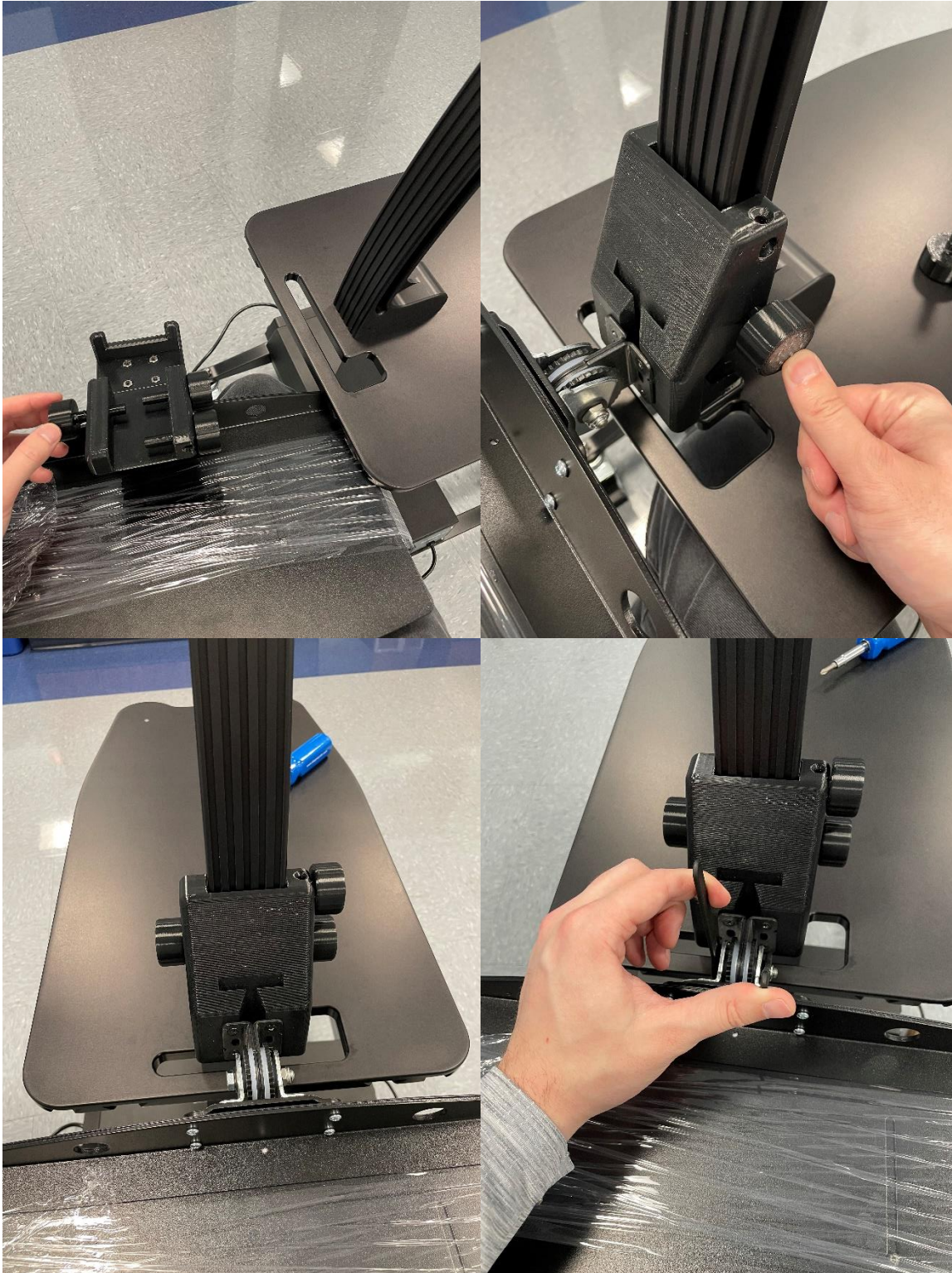

US: Diagnosys LLC; 55 Technology Drive, Suite 100, Lowell, MA 01851; 978-458-1600; sales@diagnosysllc.com
EU: Diagnosys Vision Ltd; Office 117, DOC Building, Balheary Road, Swords, Dublin, K67 E5A0, Ireland; +44 (0) 1223 520699; mail@diagnosysvision.com
UK: Diagnosys UK Ltd; 5 Trust Court, Chivers Way, Vision Park Histon, Cambridge, CB24 9PW, UK; +44 (0) 1223 520699; mail@diagnosysuk.co.uk
www.diagnosysllc.com

Profile System Setup Guide



US: Diagnosys LLC; 55 Technology Drive, Suite 100, Lowell, MA 01851; 978-458-1600; sales@diagnosysllc.com
EU: Diagnosys Vision Ltd; Office 117, DOC Building, Balheary Road, Swords, Dublin, K67 E5A0, Ireland; +44 (0) 1223 520699; mail@diagnosysvision.com
UK: Diagnosys UK Ltd; 5 Trust Court, Chivers Way, Vision Park Histon, Cambridge, CB24 9PW, UK; +44 (0) 1223 520699; mail@diagnosysuk.co.uk
www.diagnosysllc.com

Profile System Setup Guide



US: Diagnosys LLC; 55 Technology Drive, Suite 100, Lowell, MA 01851; 978-458-1600; sales@diagnosysllc.com
EU: Diagnosys Vision Ltd; Office 117, DOC Building, Balheary Road, Swords, Dublin, K67 E5A0, Ireland; +44 (0) 1223 520699; mail@diagnosysvision.com
UK: Diagnosys UK Ltd; 5 Trust Court, Chivers Way, Vision Park Histon, Cambridge, CB24 9PW, UK; +44 (0) 1223 520699; mail@diagnosysuk.co.uk
www.diagnosysllc.com

Profile System Setup Guide

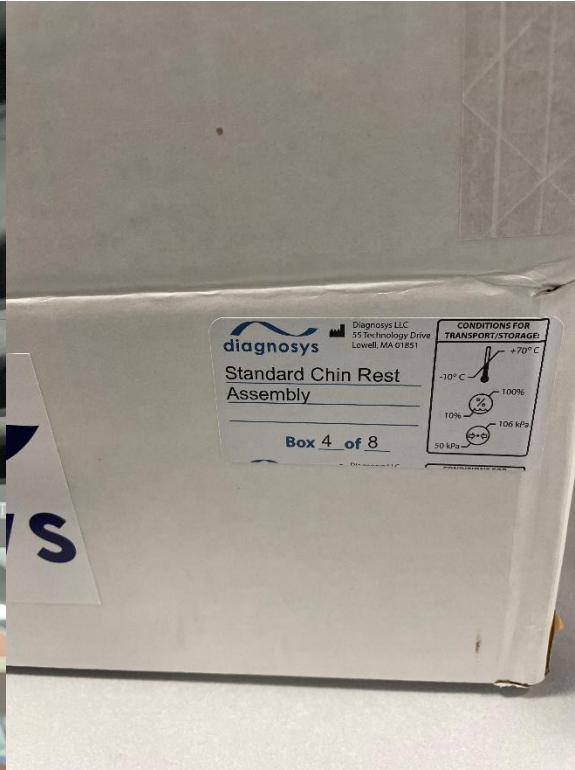

3



US: Diagnosys LLC; 55 Technology Drive, Suite 100, Lowell, MA 01851; 978-458-1600; sales@diagnosysllc.com
EU: Diagnosys Vision Ltd; Office 117, DOC Building, Balheary Road, Swords, Dublin, K67 E5A0, Ireland; +44 (0) 1223 520699; mail@diagnosysvision.com
UK: Diagnosys UK Ltd; 5 Trust Court, Chivers Way, Vision Park Histon, Cambridge, CB24 9PW, UK; +44 (0) 1223 520699; mail@diagnosysuk.co.uk
www.diagnosysllc.com

Profile System Setup Guide



Profile System Setup Guide



US: Diagnosys LLC; 55 Technology Drive, Suite 100, Lowell, MA 01851; 978-458-1600; sales@diagnosysllc.com
EU: Diagnosys Vision Ltd; Office 117, DOC Building, Balheary Road, Swords, Dublin, K67 E5A0, Ireland; +44 (0) 1223 520699; mail@diagnosysvision.com
UK: Diagnosys UK Ltd; 5 Trust Court, Chivers Way, Vision Park Histon, Cambridge, CB24 9PW, UK; +44 (0) 1223 520699; mail@diagnosysuk.co.uk
www.diagnosysllc.com

Profile System Setup Guide



US: Diagnosys LLC; 55 Technology Drive, Suite 100, Lowell, MA 01851; 978-458-1600; sales@diagnosysllc.com
EU: Diagnosys Vision Ltd; Office 117, DOC Building, Balheary Road, Swords, Dublin, K67 E5A0, Ireland; +44 (0) 1223 520699; mail@diagnosysvision.com
UK: Diagnosys UK Ltd; 5 Trust Court, Chivers Way, Vision Park Histon, Cambridge, CB24 9PW, UK; +44 (0) 1223 520699; mail@diagnosysuk.co.uk
www.diagnosysllc.com

Profile System Setup Guide



US: Diagnosys LLC; 55 Technology Drive, Suite 100, Lowell, MA 01851; 978-458-1600; sales@diagnosysllc.com
EU: Diagnosys Vision Ltd; Office 117, DOC Building, Balheary Road, Swords, Dublin, K67 E5A0, Ireland; +44 (0) 1223 520699; mail@diagnosysvision.com
UK: Diagnosys UK Ltd; 5 Trust Court, Chivers Way, Vision Park Histon, Cambridge, CB24 9PW, UK; +44 (0) 1223 520699; mail@diagnosysuk.co.uk
www.diagnosysllc.com

Profile System Setup Guide

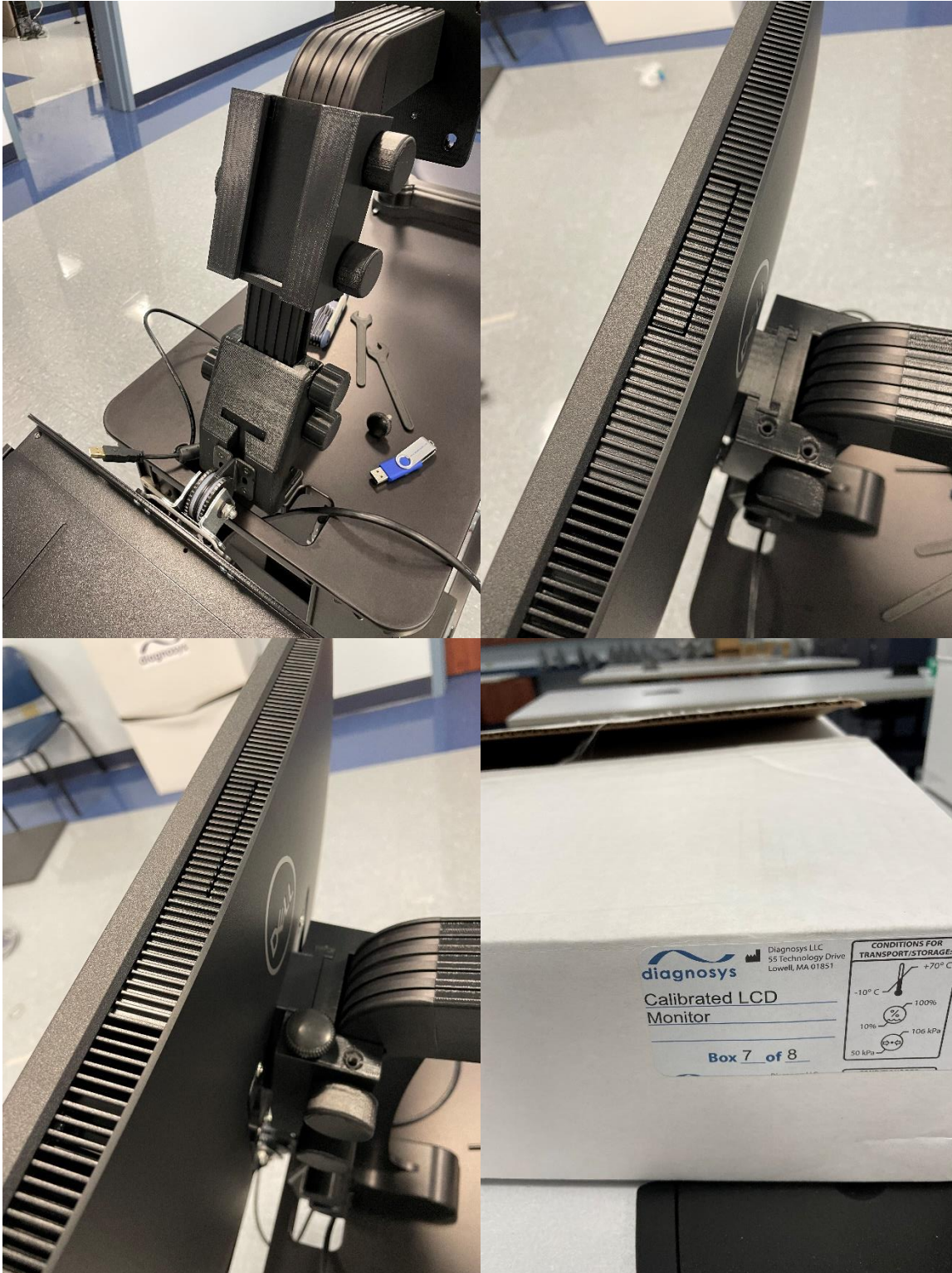

US: Diagnosys LLC; 55 Technology Drive, Suite 100, Lowell, MA 01851; 978-458-1600; sales@diagnosysllc.com

EU: Diagnosys Vision Ltd; Office 117, DOC Building, Balheary Road, Swords, Dublin, K67 E5A0, Ireland; +44 (0) 1223 520699; mail@diagnosysvision.com

UK: Diagnosys UK Ltd; 5 Trust Court, Chivers Way, Vision Park Histon, Cambridge, CB24 9PW, UK; +44 (0) 1223 520699; mail@diagnosysuk.co.uk

www.diagnosysllc.com

Profile System Setup Guide



US: Diagnosys LLC; 55 Technology Drive, Suite 100, Lowell, MA 01851; 978-458-1600; sales@diagnosysllc.com
EU: Diagnosys Vision Ltd; Office 117, DOC Building, Balheary Road, Swords, Dublin, K67 E5A0, Ireland; +44 (0) 1223 520699; mail@diagnosysvision.com
UK: Diagnosys UK Ltd; 5 Trust Court, Chivers Way, Vision Park Histon, Cambridge, CB24 9PW, UK; +44 (0) 1223 520699; mail@diagnosysuk.co.uk
www.diagnosysllc.com

Profile System Setup Guide



US: Diagnosys LLC; 55 Technology Drive, Suite 100, Lowell, MA 01851; 978-458-1600; sales@diagnosysllc.com
EU: Diagnosys Vision Ltd; Office 117, DOC Building, Balheary Road, Swords, Dublin, K67 E5A0, Ireland; +44 (0) 1223 520699; mail@diagnosysvision.com
UK: Diagnosys UK Ltd; 5 Trust Court, Chivers Way, Vision Park Histon, Cambridge, CB24 9PW, UK; +44 (0) 1223 520699; mail@diagnosysuk.co.uk
www.diagnosysllc.com

Profile System Setup Guide



US: Diagnosys LLC; 55 Technology Drive, Suite 100, Lowell, MA 01851; 978-458-1600; sales@diagnosysllc.com
EU: Diagnosys Vision Ltd; Office 117, DOC Building, Balheary Road, Swords, Dublin, K67 E5A0, Ireland; +44 (0) 1223 520699; mail@diagnosysvision.com
UK: Diagnosys UK Ltd; 5 Trust Court, Chivers Way, Vision Park Histon, Cambridge, CB24 9PW, UK; +44 (0) 1223 520699; mail@diagnosysuk.co.uk
www.diagnosysllc.com

Profile System Setup Guide



US: Diagnosys LLC; 55 Technology Drive, Suite 100, Lowell, MA 01851; 978-458-1600; sales@diagnosysllc.com
EU: Diagnosys Vision Ltd; Office 117, DOC Building, Balheary Road, Swords, Dublin, K67 E5A0, Ireland; +44 (0) 1223 520699; mail@diagnosysvision.com
UK: Diagnosys UK Ltd; 5 Trust Court, Chivers Way, Vision Park Histon, Cambridge, CB24 9PW, UK; +44 (0) 1223 520699; mail@diagnosysuk.co.uk
www.diagnosysllc.com

Profile System Setup Guide



US: Diagnosys LLC; 55 Technology Drive, Suite 100, Lowell, MA 01851; 978-458-1600; sales@diagnosysllc.com
EU: Diagnosys Vision Ltd; Office 117, DOC Building, Balheary Road, Swords, Dublin, K67 E5A0, Ireland; +44 (0) 1223 520699; mail@diagnosysvision.com
UK: Diagnosys UK Ltd; 5 Trust Court, Chivers Way, Vision Park Histon, Cambridge, CB24 9PW, UK; +44 (0) 1223 520699; mail@diagnosysuk.co.uk
www.diagnosysllc.com

Profile System Setup Guide

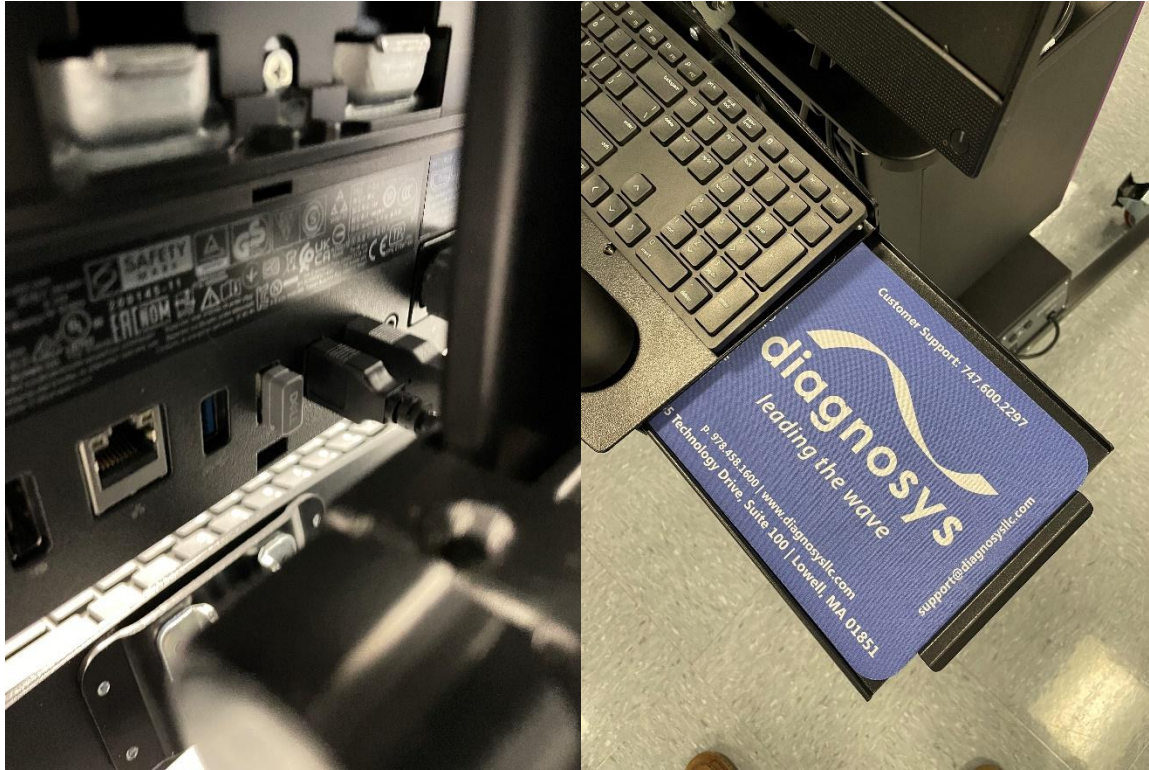

US: Diagnosys LLC; 55 Technology Drive, Suite 100, Lowell, MA 01851; 978-458-1600; sales@diagnosysllc.com
EU: Diagnosys Vision Ltd; Office 117, DOC Building, Balheary Road, Swords, Dublin, K67 E5A0, Ireland; +44 (0) 1223 520699; mail@diagnosysvision.com
UK: Diagnosys UK Ltd; 5 Trust Court, Chivers Way, Vision Park Histon, Cambridge, CB24 9PW, UK; +44 (0) 1223 520699; mail@diagnosysuk.co.uk
www.diagnosysllc.com

Profile System Setup Guide



Profile System Setup Guide



Profile System Setup Guide



Profile System Setup Guide



Profile System Setup Guide

Colordome cart (OR arm or slider) with 27" LCD auxiliary cart

Complete Colordome cart with OR arm and 27" LCD dead cart depicted below. LCD dead cart does not have control box or power unit.



Profile System Setup Guide

